

Retainers—Type E

Create a part number:

Length		Material		Finish
FCXXX-XXX		XX		XX

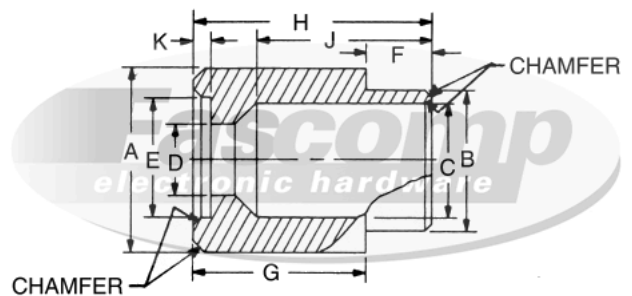

Retainers Type E													
FCXXX-XXX	Thd	Panel Thickness	A +.004 -.004	B +.000 -.003	C +.004 -.001	D +.004 -.001	E +.005 -.000	F +.005 -.005	G +.005 -.005	H +.010 -.010	J +.005 -.005	K +.010 -.000	
FC1033-062	4-40	.052 - .067	9/32	.250	.210	.125	.192	.062	.375	7/16	.299	.078	
FC1033-093	4-40	.084 - .099	9/32	.250	.210	.125	.192	.093	.344	7/16	.299	.078	
FC1033-125	4-40	.109 - .140	9/32	.250	.210	.125	.192	.125	.312	7/16	.299	.078	
FC1033-187	4-40	.171 - .203	9/32	.250	.210	.125	.192	.187	.250	7/16	.299	.078	
FC1033-250	4-40	.234 - .265	9/32	.250	.210	.125	.192	.250	.187	7/16	.299	.078	
FC1034-062	6-32	.052 - .067	9/32	.250	.210	.150	.192	.062	.375	7/16	.305	.078	
FC1034-093	6-32	.084 - .099	9/32	.250	.210	.150	.192	.093	.344	7/16	.305	.078	
FC1034-125	6-32	.109 - .140	9/32	.250	.210	.150	.192	.125	.312	7/16	.305	.078	
FC1034-187	6-32	.171 - .203	9/32	.250	.210	.150	.192	.187	.250	7/16	.305	.078	
FC1034-250	6-32	.234 - .265	9/32	.250	.210	.150	.192	.250	.187	7/16	.305	.078	
FC1035-062	8-32	.052 - .067	17/32	.433	.386	.175	.312	.062	.562	5/8	.427	.093	
FC1035-093	8-32	.084 - .099	17/32	.433	.386	.175	.312	.093	.532	5/8	.427	.093	
FC1035-125	8-32	.109 - .140	17/32	.433	.386	.175	.312	.125	.500	5/8	.427	.093	
FC1035-187	8-32	.171 - .203	17/32	.433	.386	.175	.312	.187	.437	5/8	.427	.093	
FC1035-250	8-32	.234 - .265	17/32	.433	.386	.175	.312	.250	.375	5/8	.427	.093	
FC1036-062	10-24	.052 - .067	17/32	.433	.386	.203	.312	.062	.562	5/8	.432	.093	
FC1036-093	10-24	.084 - .099	17/32	.433	.386	.203	.312	.093	.532	5/8	.432	.093	
FC1036-125	10-24	.109 - .140	17/32	.433	.386	.203	.312	.125	.500	5/8	.432	.093	
FC1036-187	10-24	.171 - .203	17/32	.433	.386	.203	.312	.187	.437	5/8	.432	.093	
FC1036-250	10-24	.234 - .265	17/32	.433	.386	.203	.312	.250	.375	5/8	.432	.093	
FC1037-062	10-32	.052 - .067	17/32	.433	.386	.203	.312	.062	.562	5/8	.432	.093	
FC1037-093	10-32	.084 - .099	17/32	.433	.386	.203	.312	.093	.532	5/8	.432	.093	
FC1037-125	10-32	.109 - .140	17/32	.433	.386	.203	.312	.125	.500	5/8	.432	.093	
FC1037-187	10-32	.171 - .203	17/32	.433	.386	.203	.312	.187	.437	5/8	.432	.093	
FC1037-250	10-32	.234 - .265	17/32	.433	.386	.203	.312	.250	.375	5/8	.432	.093	
FC1038-062	12-24	.052 - .067	17/32	.433	.386	.228	.312	.062	.562	5/8	.438	.093	
FC1038-093	12-24	.084 - .099	17/32	.433	.386	.228	.312	.093	.532	5/8	.438	.093	
FC1038-125	12-24	.109 - .140	17/32	.433	.386	.228	.312	.125	.500	5/8	.438	.093	
FC1038-187	12-24	.171 - .203	17/32	.433	.386	.228	.312	.187	.437	5/8	.438	.093	
FC1038-250	12-24	.234 - .265	17/32	.433	.386	.228	.312	.250	.375	5/8	.438	.093	
FC1039-062	1/4-20	.052 - .067	17/32	.433	.386	.257	.312	.062	.562	5/8	.445	.093	
FC1039-093	1/4-20	.084 - .099	17/32	.433	.386	.257	.312	.093	.532	5/8	.445	.093	
FC1039-125	1/4-20	.109 - .140	17/32	.433	.386	.257	.312	.125	.500	5/8	.445	.093	
FC1039-187	1/4-20	.171 - .203	17/32	.433	.386	.257	.312	.187	.437	5/8	.445	.093	
FC1039-250	1/4-20	.234 - .265	17/32	.433	.386	.257	.312	.250	.375	5/8	.445	.093	
FC1040-062	1/4-28	.052 - .067	17/32	.433	.386	.257	.312	.062	.562	5/8	.445	.093	
FC1040-093	1/4-28	.084 - .099	17/32	.433	.386	.257	.312	.093	.532	5/8	.445	.093	
FC1040-125	1/4-28	.109 - .140	17/32	.433	.386	.257	.312	.125	.500	5/8	.445	.093	
FC1040-187	1/4-28	.171 - .203	17/32	.433	.386	.257	.312	.187	.437	5/8	.445	.093	
FC1040-250	1/4-28	.234 - .265	17/32	.433	.386	.257	.312	.250	.375	5/8	.445	.093	

Material	
Material Code (XX)	
B	Brass
S	Steel
SS	Stainless Steel

Compatible Finish	
B, S, SS	0 - Plain
B, S	5 - Nickel Plate (QQ-N-290)
B, S	12 - Zinc Clear (ASTM-B-633)
B, S	16 - Electro Tin (MIL-T-10727 TYPE 1)
SS	20 - Passivation (MIL-F-14072D)
B, S, SS	26 - Black Oxide
B, S	28 - Zinc Yellow (ASTM-B-633)

Source Control Drawing:
To be produced by
Fascomp Electronic Hardware

Tolerances
Unless otherwise Specified
.xxx +/- .005
.xx +/- .010
Angular +/- 1 Degree
Linear +/- .005
Break all sharp edges

This document is the property of Fascomp Inc. and shall not be reproduced, distributed, or used as a basis for manufacturing without written permission from Fascomp Inc.

